

Item No: _____
 Model No: _____
 Qty: _____
 Project: _____

Drop In Coved Corner Sinks

- Heavy duty stainless steel construction
- Faucet holes on 4" centres (8" on DI-2-19168)
- 3.5" centre drain hole, drain basket included

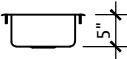
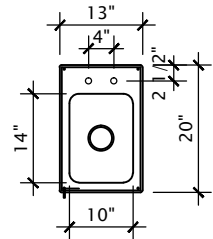
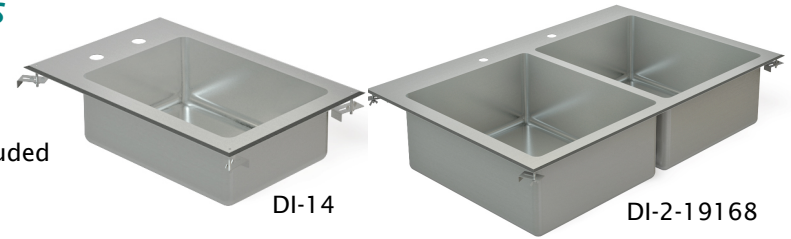

DI-14

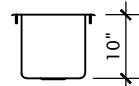
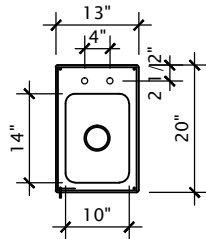

DI-141010

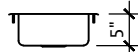
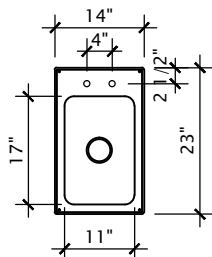

DI-17115

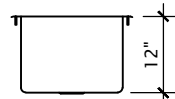
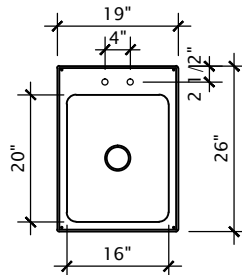

DI-201612

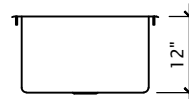
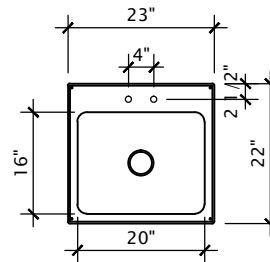

DI-1162012

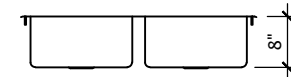
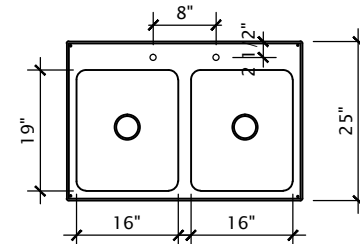

DI-2-19168

Model No.	Description	Bowl Size D x L x H	Overall Size D x L x H	Weight lbs.
DI-14	Drop In Sink	14" x 10" x 5"	20" x 13" x 5"	10
DI-141010	Drop In Sink	14" x 10" x 10"	20" x 13" x 5"	12
DI-1162012	Drop In Sink	16" x 20" x 12"	22" x 23" x 12"	17
DI-201612	Drop In Sink	20" x 16" x 12"	26" x 19" x 12"	20
DI-17115	Drop In Sink	17" x 11" x 5"	21" x 13" x 5"	15
DI-2-19168	Two Compartment Drop In Sink	19" x 16" x 8"	24" x 36.5" x 8"	30

Sizes nominal, detailed specifications available upon request. Specifications subject to change without notice.



C US
U.P. Code

ASME A112.19.3/CSA B45.4

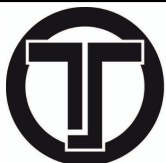

TARRISON

Corporate Head Office
 2780 Coventry Road,
 Oakville, Ontario, L6H 6R1
 Phone: 905-825-9665
 Fax: 905-825-0965
 info@tarrison.com
 www.tarrison.com

US Distribution Center
 150 Gratiot Blvd,
 Marysville, MI 48040
 info@tarrison.com
 www.tarrison.com